

1. Dimensions of XLH 9LED (without bracket B)

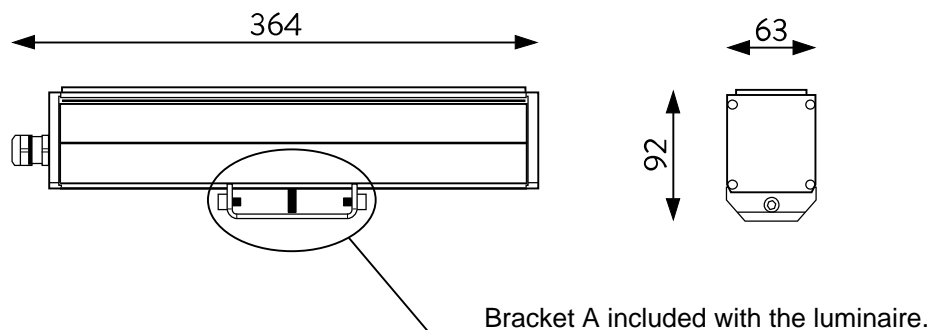

2. Mechanical assembly

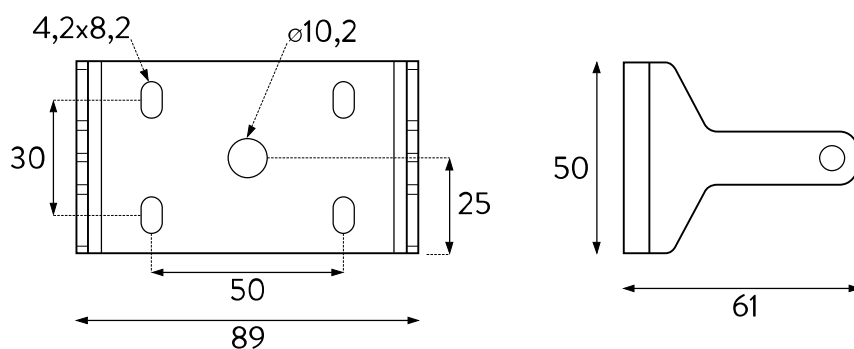

1. Mount bracket B on the surface using expansion plugs.
2. Adjust the position of bracket A on the fixture and secure it to the housing.
3. Slide the fixture with bracket A into bracket B and tighten the side screws.
4. Adjust the tilt angle of the fixture and tighten the side screws.

3. Dimensions of XLH 18LED (without bracket B)

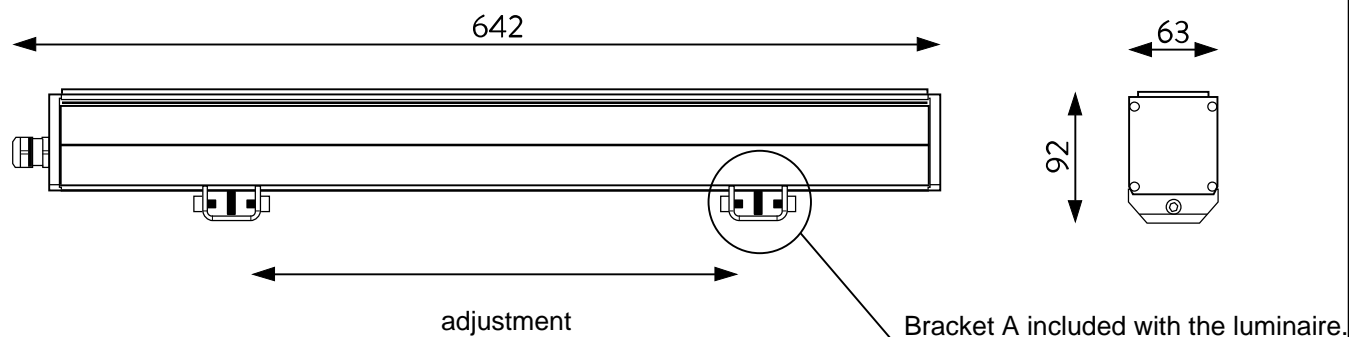

4. Mechanical assembly

Bracket B (ordered separately)

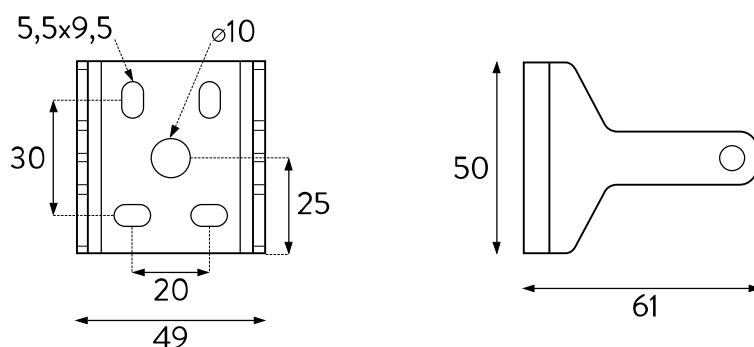

1. Mount bracket B on the surface using expansion plugs.
2. Adjust the position of bracket A on the fixture and secure it to the housing.
3. Slide the fixture with bracket A into bracket B and tighten the side screws.
4. Adjust the tilt angle of the fixture and tighten the side screws.