

To ensure correct use, please read these instructions carefully.

- All luminaires must be installed by a qualified electrician.
- Installation and replacement of damaged luminaires, cleaning and other service works must be carried out by a qualified personnel with power disconnected.
- Make sure the cables are connected to the corresponding connector terminals. For luminaires with emergency power module, use an additional connector between the battery and the converter.
- Any work related to LED Modules must be done in electrostatic gloves. None of their use may result in loss of warranty.
- The luminaire is powered by mains voltage 220 - 240V 50Hz

WARNING:

The selection of the right assembly elements (eg mounting dowels) suitable for the mounting surface belongs to the installer.

For safety reasons, it is necessary to read these instructions before starting the assembly. The instructions should be kept for future purposes. The fitting being the subject of these instructions must be used according to its original purpose. Fittings can be installed only by persons who are trained and duly authorized to do so.

1. The Producer has the exclusive right to introduce modifications to the product.
2. The Producer shall not be held liable for the following:
 - damages which occur after the product has been modified by a user,
 - damages to the product resulting from installation not carried out in compliance with the instruction for assembly, installation by unauthorized persons or damages resulting from unsuitable storage,
 - the product getting dirty during assembly if the person carrying out the assembly does not wear disposable gloves.
3. While mounting luminaires stiffness and carrying capacity provided by ceiling manufacturers have to be taken into consideration. (Concentrated and Uniformly Distributed Load)

Notice:

Ceiling-type fittings must not be covered with an insulating mat

Maintenance

During the exploitation period of lighting it is necessary to inspect the fittings in order to detect malfunctions and mechanical damages, as well as impurities, in particular those of elements in the optical system.

1. Before proceeding to the inspection of a fitting, the power supply must be turned off.
2. Elements of the fitting which get used up or damaged in the course of standard exploitation must immediately be replaced with new and defect-free elements.
3. The fitting and its elements (glass, painted surface) can be cleansed with biodegradable liquids using soft washcloth and after removing impurities they need to be dried (with a dryer or wiped with a dry washcloth). OPAL and MPR surfaces, rasters, reflectors should be blown over with compressed air. Lighting fixtures used to illuminate the premises and the surface.
4. Any work related to LED Modules must be done in electrostatic gloves. None of their use may result in loss of warranty.

The fittings do not pose any threats to the safety of humans or property, provided that they are properly installed, maintained and used in compliance with their original purpose.

The use of lighting fittings produced by Millia Light.

Lighting fittings produced by Millia Light are aimed for use in standard conditions, with the exception of special-purpose fittings. Standard conditions are featured by ambient temperature of +5°C ÷ +35°C pressure of 960-1020 hPa, and humidity of 10 - 75%. Such conditions prevail on the European territory.

The fittings should not be used, if the environmental conditions could harm the structure of a fitting, top coats or electronic component parts placed inside the fitting, causing malfunction of the fitting. The risks factors include i.a. high temperature, excessive humidity, dustiness, the presence of chemically significant substances in the atmosphere (chlorine, salt, acids, alkali), vibrations, shock, exposure to shock, UV radiation, electromagnetic fields. The fittings must be used according to their original purpose. They must be installed according to the installation instructions, solely by persons authorized to do so.

Notice:

In luminaires with a OPAL or MPR diffuser, the diffusers are cut 1mm/1m shorter than the length of the profile due to thermal expansion of the diffuser. In OPAL, MPR, Asym, Louvre luminaires it is not allowed to install the luminaire with the shutter by pressing the shutter!

Source of light

The light source used in this luminaire should be replaced only by the manufacturer or his service representative or a similarly qualified person.

1

PROLINE 60
SURFACE

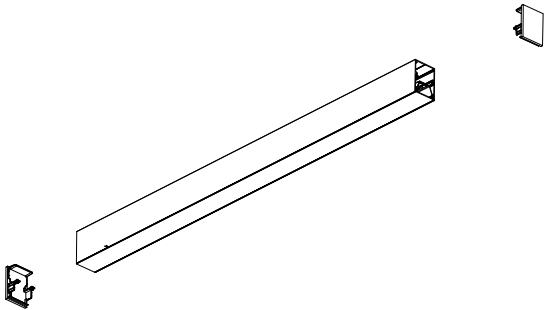

3

Mounting holes - dimensions

L - total luminaire length
A - luminaire length without end caps
B - hole spacing

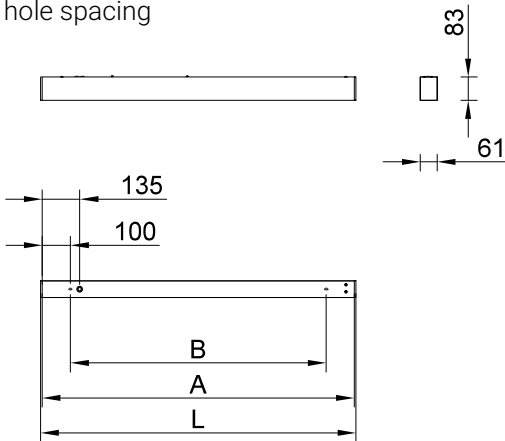

5

Turn off power supply

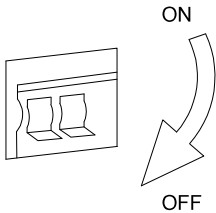

2

surface mounting

Surface mounting

points 3 - 22

Suspended mounting

points 23 - 70

4

Mounting holes - dimensions

luminaire length	hole spacing
A	B
561	361
841	641
1121	921
1401	1201
1681	1481
1961	1761
2241	2041
Non-standard length	Real measure

6

Trace and drill mounting holes, use suitable dowels and screws for the given surface

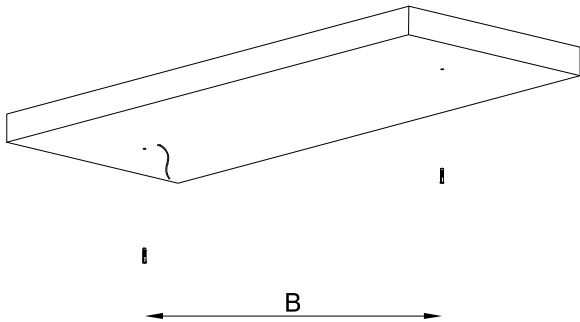

7

Remove the diffuser (OPAL) from the housing

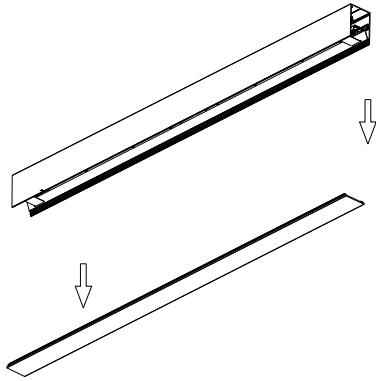

8

Remove the protective elements from the housing

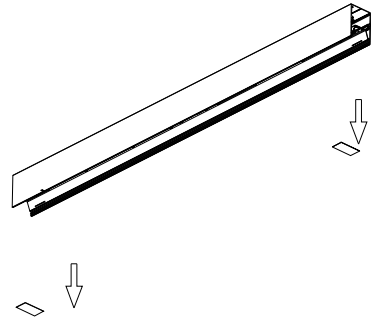

9

Remove the reflector with LED modules from the luminaire (magnet mount)

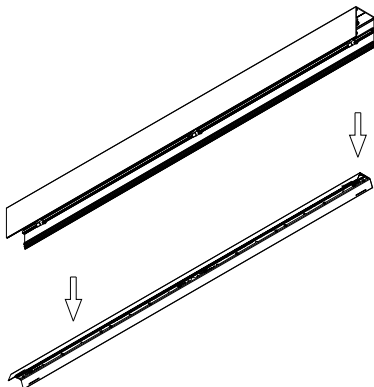

10

Fasten the luminaire

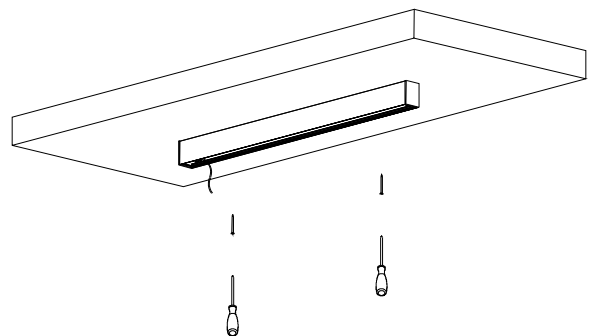

11

Connect the power supply in the accordance to markings and DALI cables (if provided)



L
N

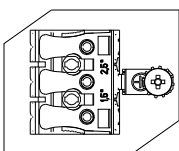

DA+
DA-

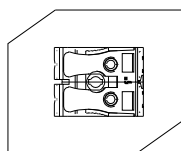

Points 12 -14

Only if fittings are installed in line

12

Push the line connector into the housing

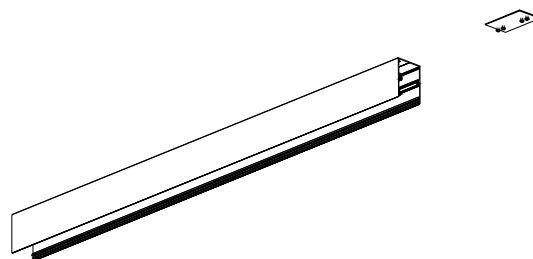

13

Wedge the line connector in the housing by tightening the screws. Slide the side connectors into the housing

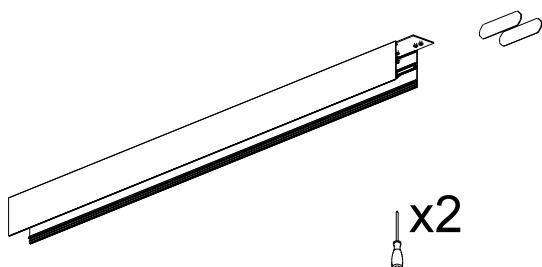

14

Attach the second fitting. Wedge the line connector in the housing by tightening the screws. Connect the quick couplings between the two fittings (if provided)

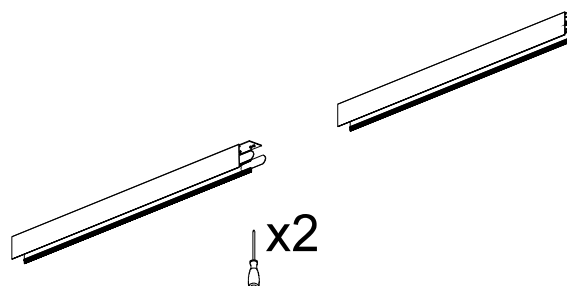

15

Mount encaps

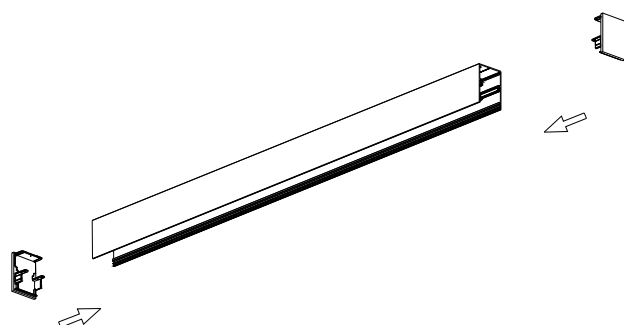

16

Screw endcaps to the luminaire body

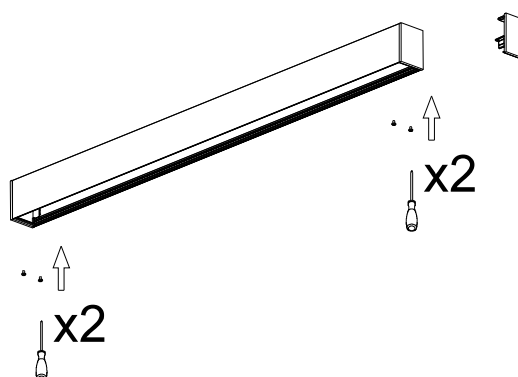

17

Connect the electric fast connector. Insert and screw the base with LED source into the luminaire housing

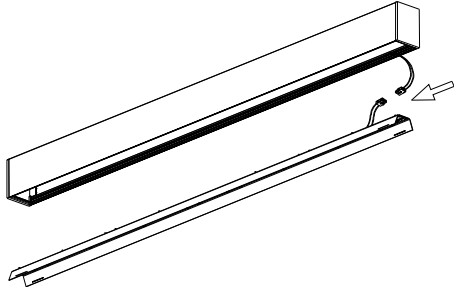

18

Insert the protective elements into the housing

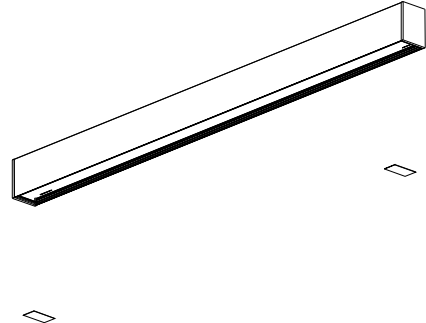

19

Make sure that the security elements are properly fitted

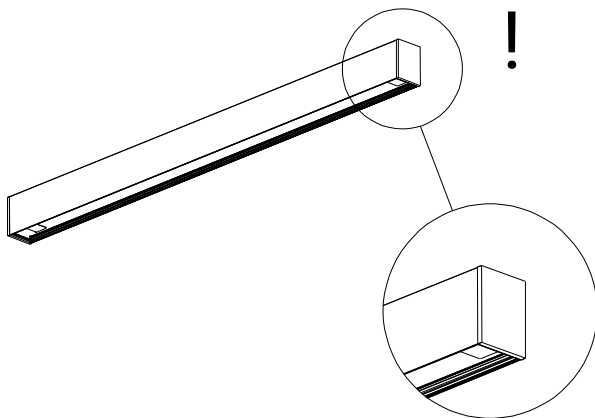

20

Mount the diffuser into the luminaire

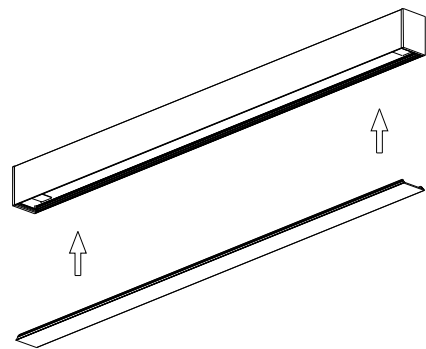

21

Clean the luminaire

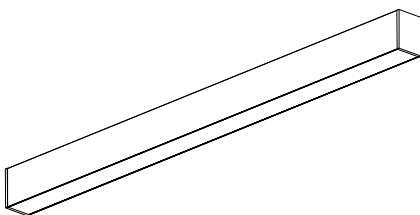

22

Turn on power supply

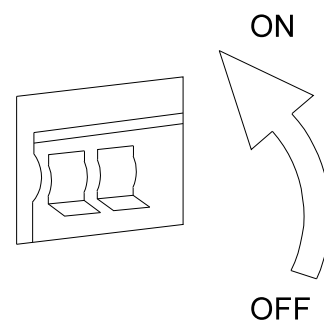

23

**PROLINE 60
PENDANT**

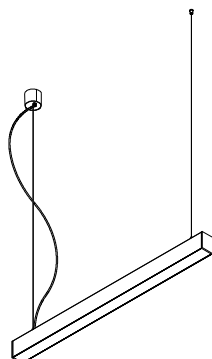

24

suspended mounting

If the luminaire is assembled by the manufacturer follow the points in the remaining 25- 39
in other cases please follow the points 40-70.

25

Turn off power supply

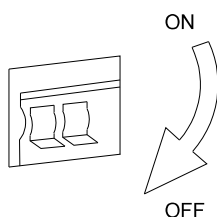

26

Mounting holes - dimensions

L - total luminaire length

A - luminaire length without end caps

B - hole spacing

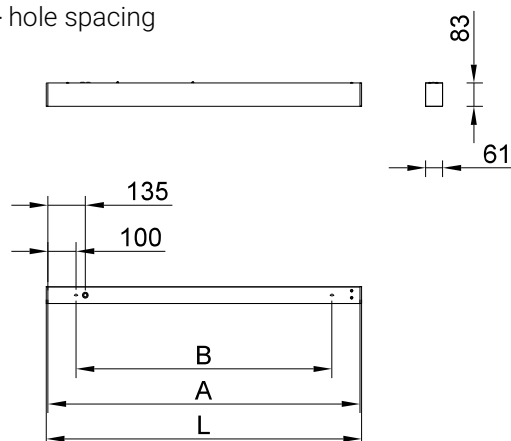

27

Mounting holes - dimensions

luminaire lenght	hole spacing
A	B
561	361
841	641
1121	921
1401	1201
1681	1481
1961	1761
2241	2041
Non-standard lenght	Real measure

28

**Trace and drill mounting holes, use sutable
dowels
and screws for the given surface**

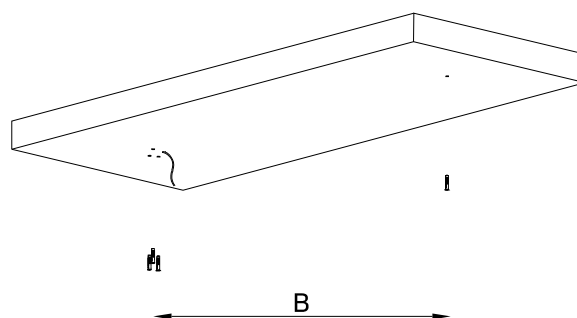

29

ver. A

Mark and drill the mounting holes for soffits

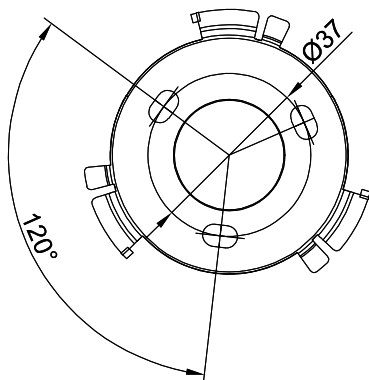

31

ver. C

Mark and drill the mounting holes for soffits

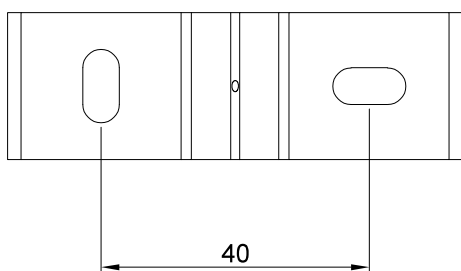

33

Connect the power supply in the accordance to markings and DALI cables (if provided)

EVG

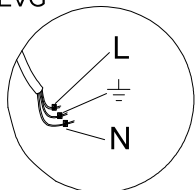

EVG
DALI

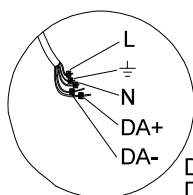

DA+ - Dali +
DA- - Dali -

30

ver. B

Mark and drill the mounting holes for soffits

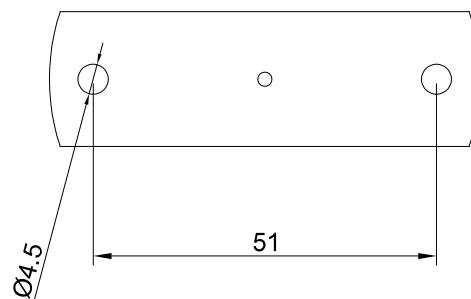

32

Mount the brackets

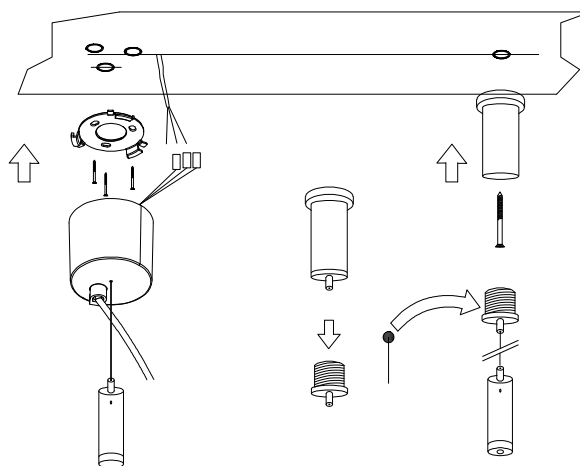

34

ver. A

Pull the cover to the ceiling and lock it by turning

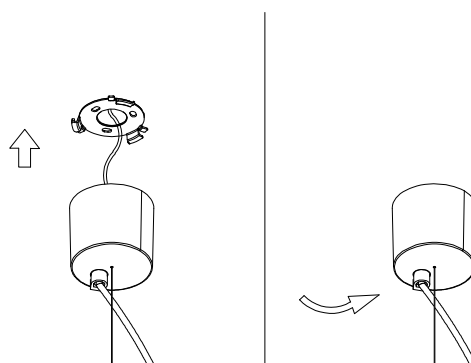

35

ver. B

Pull the cover to the ceiling and lock it by turning stopper

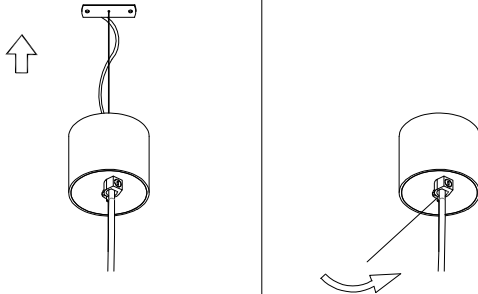

36

suspended mounting

ver. C

Pull the cover to the ceiling and lock it by turning stopper

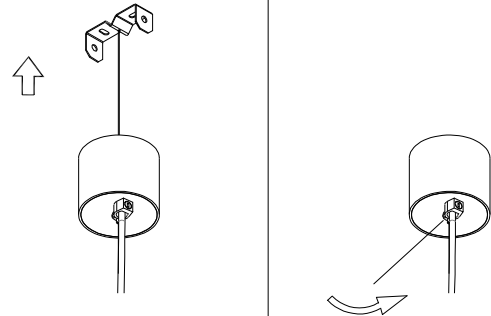

37

Hang the luminaire on the prepared suspension set

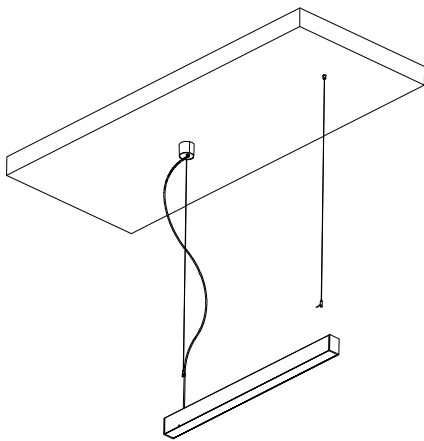

38

Clean and level the luminaire

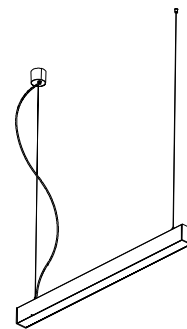

39

Turn on power supply

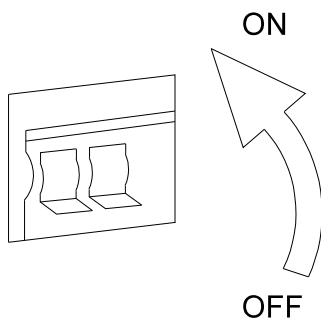

40

PROLINE 60 PENDANT

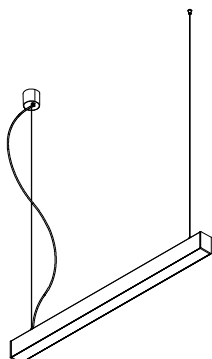

42

Mounting holes - dimensions

luminaire lenght	hole spacing
A	B
561	361
841	641
1121	921
1401	1201
1681	1481
1961	1761
2241	2041
Niestandardowa długość Non-standard lenght	Pomiar z natury Real measure

44

Trace and drill mounting holes, use sutable dowels and screws for the given surface

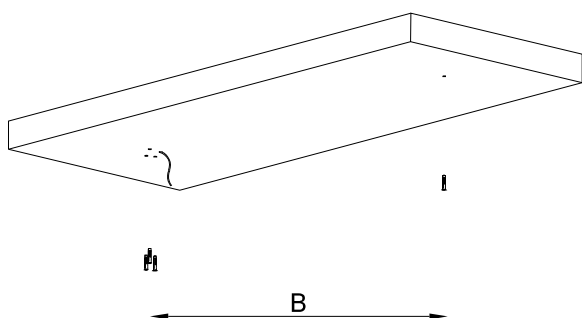

41

suspended mounting

Mounting holes - dimensions

L - total luminaire length
A - luminaire length without end caps
B - hole spacing

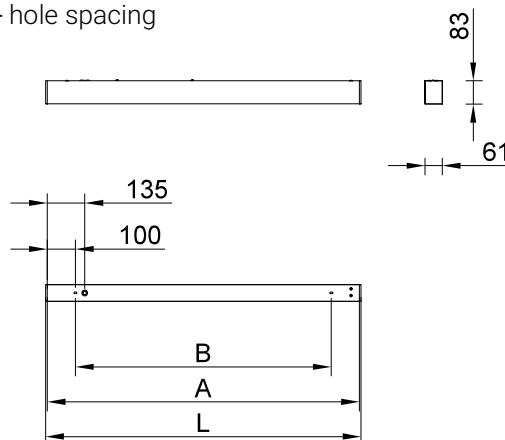

43

Turn off power supply

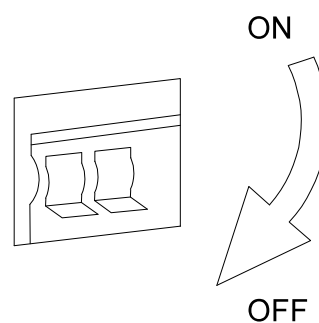

45

ver. A

Mark and drill the mounting holes for soffits

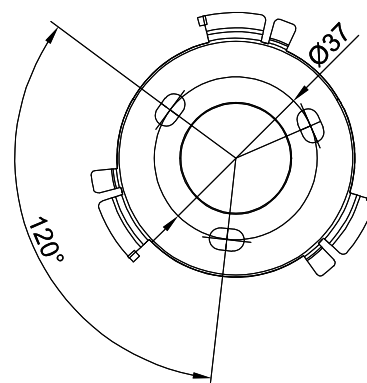

46

ver. B

Mark and drill the mounting holes for soffits

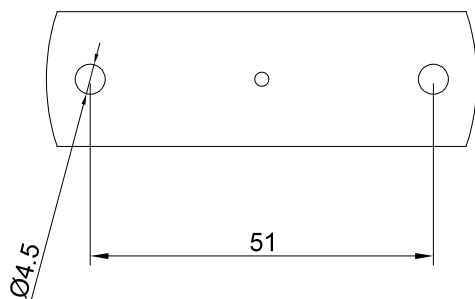

47

suspended mounting

ver. C

Mark and drill the mounting holes for soffits

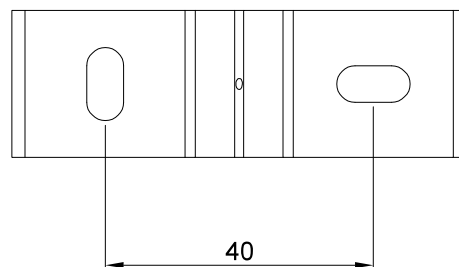

48

Mount the brackets

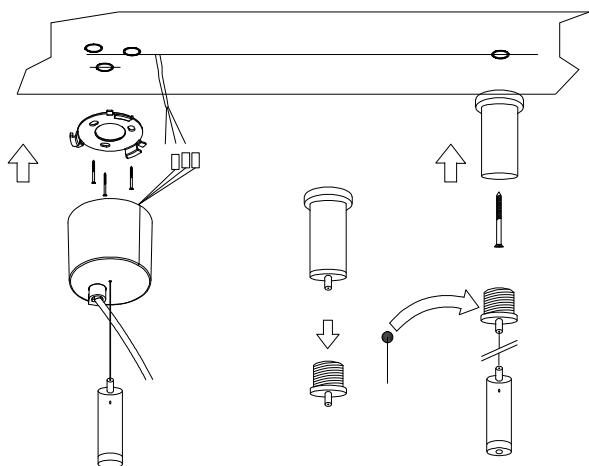

49

Connect the power supply in the accordance to markings and DALI cables (if provided)

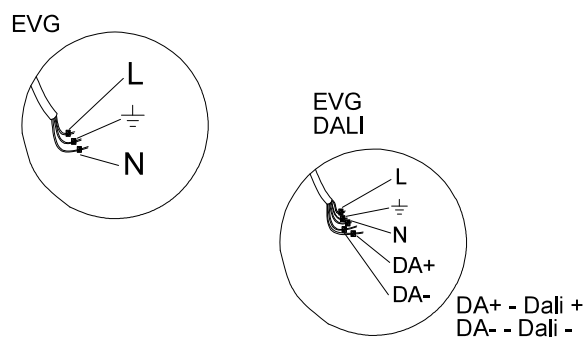

50

ver. A

Pull the cover to the ceiling and lock it by turning stopper

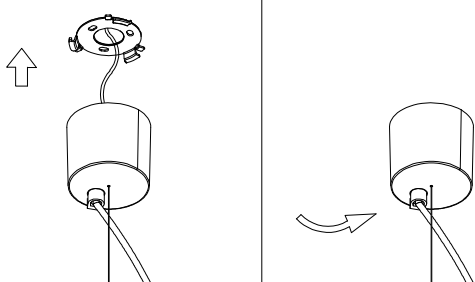

51

ver. B

Pull the cover to the ceiling and lock it by turning stopper

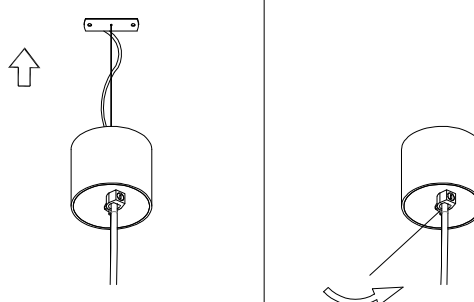

52

ver. C

Pull the cover to the ceiling and lock it by turning stopper

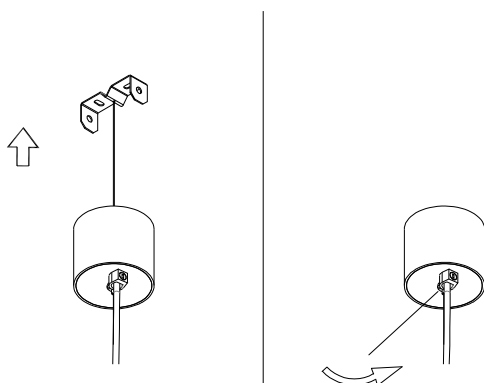

53

suspended mounting

Proceed with the installation of the luminaire

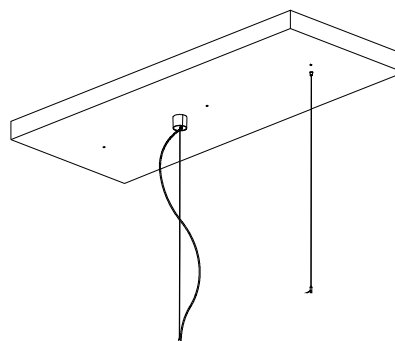

54

Remove the diffuser (OPAL, MPR) from the housing

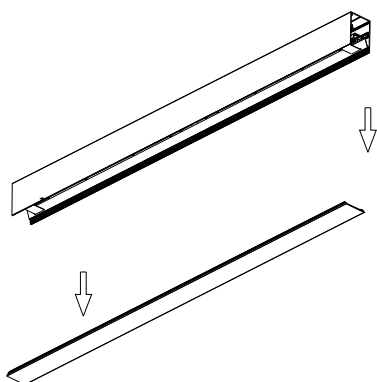

55

Remove the protective elements from the housing

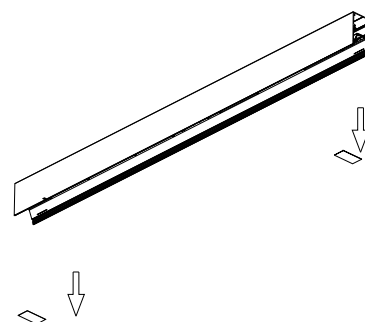

56

Remove the reflector with LED modules from the luminaire (magnet mount)

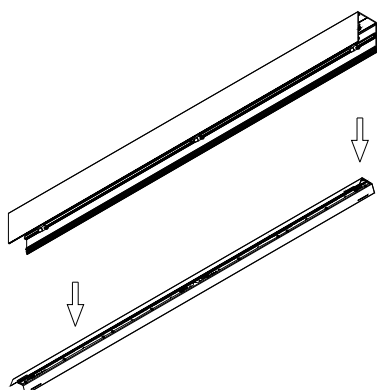

57

Screw the luminaire body onto the prepared suspension set

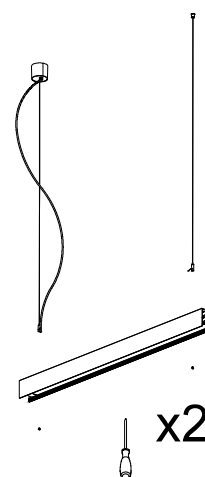

58

Pass the power cord through the luminaire body

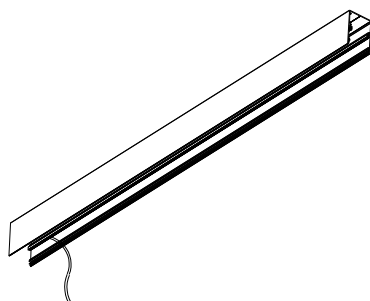

59

suspended mounting

Connect the power supply in the accordance to markings and DALI cables (if provided)

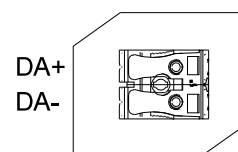
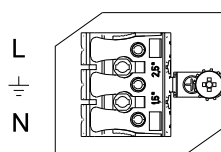

60

Push the line connector into the housing

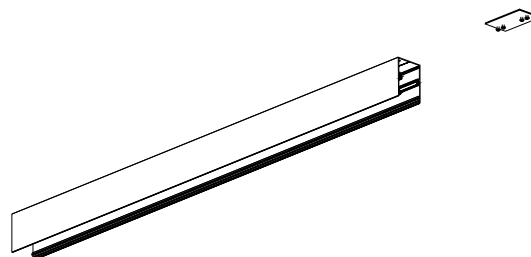

Points 60 -
62

Only if fittings are installed in line

61

Wedge the line connector in the housing by tightening the screws. Slide the side connectors into the housing

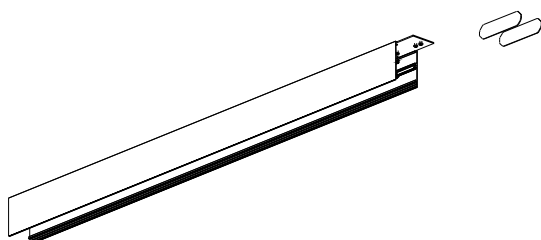

62

Attach the second fitting. Wedge the line connector in the housing by tightening the screws. Connect the quick couplings between the two fittings (if provided)

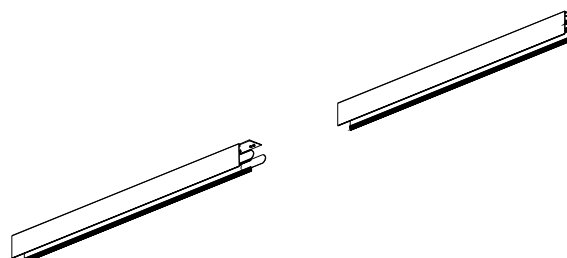

63

Mount encaps

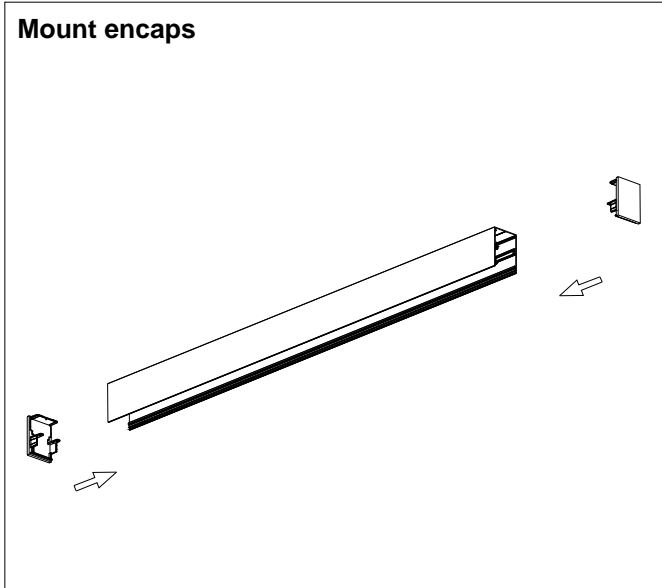

64

suspended mounting

Screw endcaps to the luminaire body

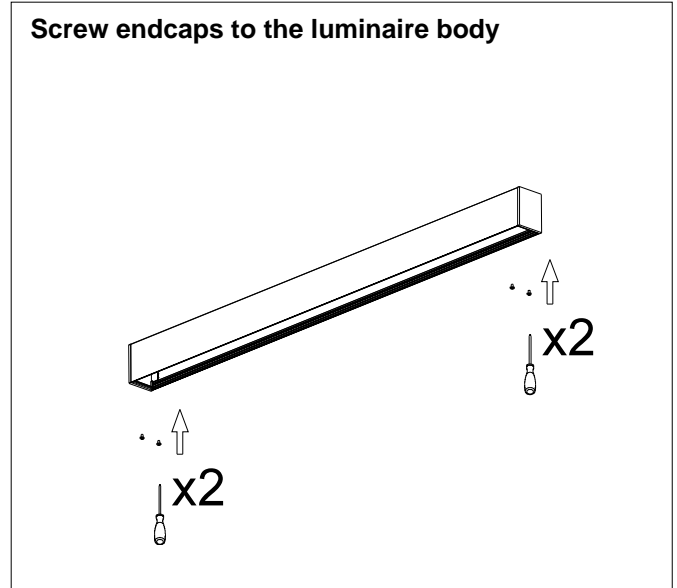

65

Connect the electric fast connector. Insert and screw the base with LED source into the luminaire housing

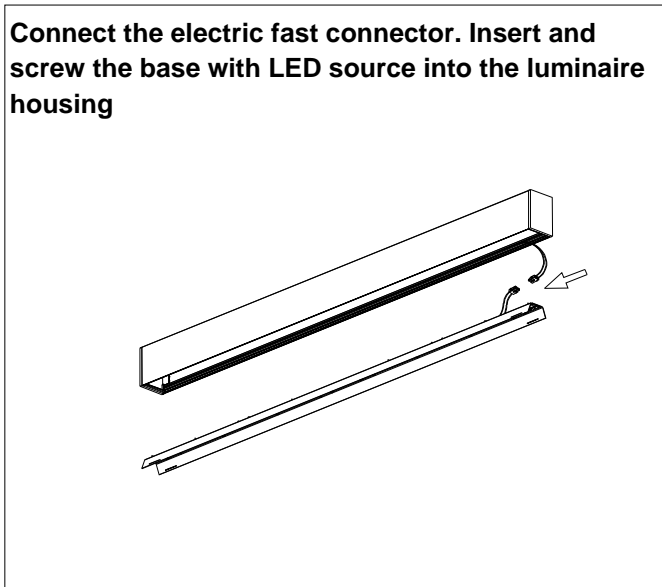

66

Insert the protective elements into the housing

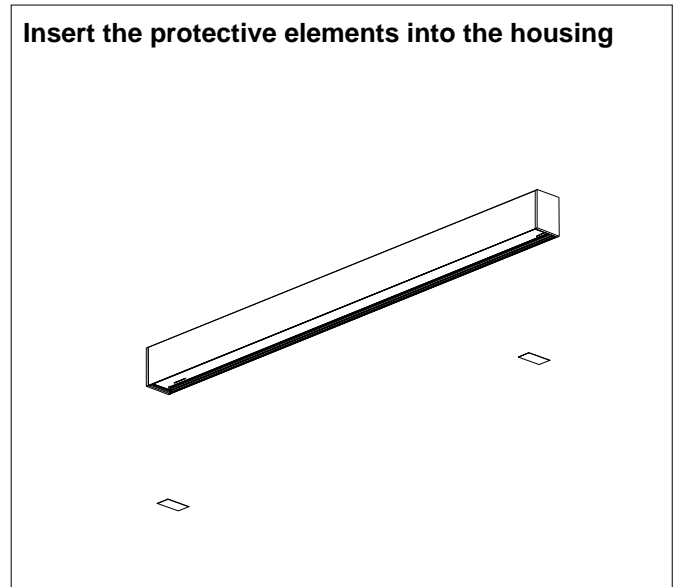

67

Make sure that the security elements are properly fitted

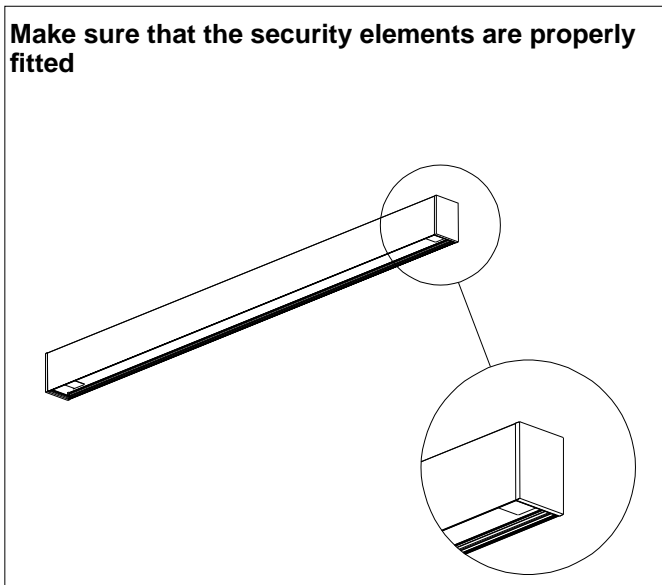

68

Mount the diffuser into the luminaire

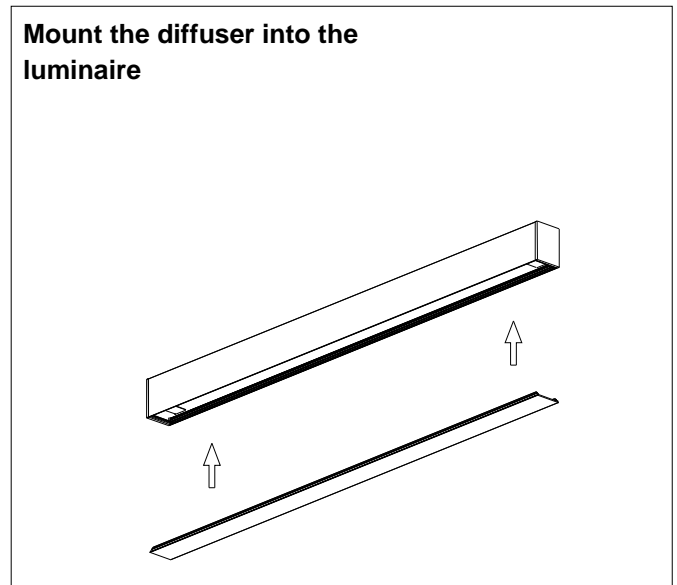

69

Clean and level the luminaire

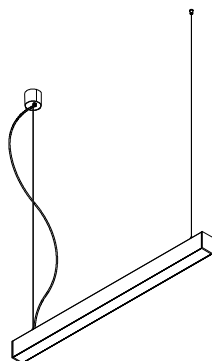

70

suspended mounting

Turn on power
supply

